

## Optical Fiber Distribution Box

### TECHNICAL DATA SHEET

#### **24 Fiber Optic Termination Box - Plastic ABS - Outdoor IP66, UV & Rainfall Resistant - Wall Mounting and Pole Mounting Application**



## **24 Fiber Optic Termination Box -Plastic ABS - Outdoor IP66, UV & Rainfall Resistant - Wall Mounting and Pole Mounting Application**

### **Description:**

The fiber optic terminal box is suitable for optical fiber splitting/splicing using. It is reasonable design for fiber arrangement, and its bend radius is more than 30mm

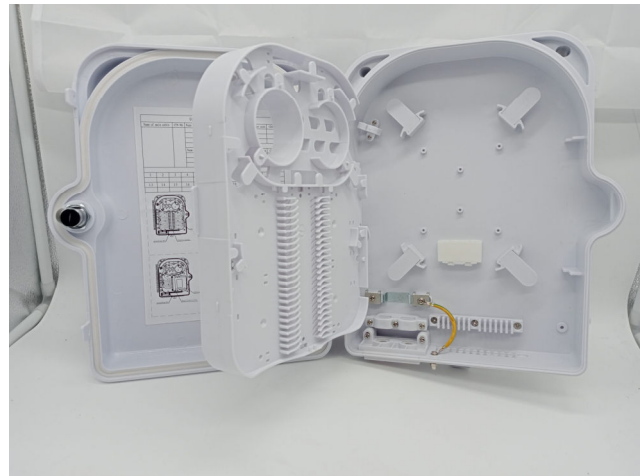

### **Features**

- Industry Standard User Interface, be made of ABS plastic.
- Can accommodate 1x4,1x8,1X16, 2x4,2x8 & 2x16 PLC steel tube splitter.
- Rainfall resistant, outdoor using.
- Can load 24pcs LC, FC, ST, SC ... adapters.
- Wall mounting and pole mounting application.
- 2pcs cable entry ports; cable can be entry without cutting.
- 24pcs exit ports for FTTH drop cable.

**Specification:**

Model	Capacity	Dimension	Remark
FLOFLBA BSIP6624	Max. 24 fibers	274.3x313.4x114.1mm	Can load max.2pcs splitter box Can load max.24pcs SC simplex, FC simplex, LC duplex ... adapters

**Application:**

- FTTH access network.
- Telecommunication Networks
- CATV Networks